

# INSTALL/REMOVAL INSTRUCTIONS: EVAP PRESSURE SENSOR REPAIR KIT

**ATTENTION:** Refer to the appropriate shop manual for your vehicle to obtain specific service procedures for this part. If you do not have a service manual or lack the skill to install this part, it is recommended that you seek the services of a qualified technician. Pay special attention to all cautions and warnings included in the shop manual. Read and follow all instructions carefully.

## REMOVAL/INSTALL OF EVAP PRESSURE SENSOR REPAIR KIT (911-260) Ford 2014–00, Lincoln 2009–07, Mercury 2010–02

**PLEASE WEAR  
SAFETY GLASSES!**

### Tools needed to fit the EVAP Pressure Sensor Repair kit:

- A sharp cutting tool or box knife
- A tape measure
- An adjustable wrench
- The Service Manual to your model for the following steps:
  - a. If your vehicle is in the 2002–2004 model range of Ford trucks, please consult your Service Manual for the pin outs for the connector to the vent sensor. A pigtail may be needed for your model, and you may need electrical pliers to strip and crimp the wires to butt splices supplied by this kit. The butt splices have shrink tube and can be heated to shrink. Take caution and do not use open flame or electrical power when fuel vapors are present.
  - b. The fuel tank will need to be removed for many models. Check your Service Manual to find what is required to access your EVAP pressure sensor.

---

### Removal Instructions

**STEP 1:** Disconnect battery.

**STEP 2:** Get full access to the inline EVAP sensor line in the area of the vent sensor. On most models, this will require removing the fuel tank to get access above the fuel tank.

**STEP 3:** Measure the hose in the kit against the nylon lines (or use a tape measure) from the sensor to the next barb or connection. If it is longer than the hose supplied, you will need to use the compression fitting in the kit. If it is the same or less than the hose in the kit, you will be able to fit barb to barb with hose only.

**STEP 4:** Remove the old sensor and nylon line.

#### Disclaimer:

Even though every attempt is made to ensure this information is complete and accurate, it is impossible to account for all possible circumstances or situations. Please consult with a qualified auto technician before attempting to perform any work you are not qualified to do. Automobiles can be hazardous to work on; be sure to take all necessary safety precautions. Failure to do so may result in property damage or personal injury. Certain motor vehicle standards and performance requirements may apply to your motor vehicle (such as Federal Motor Vehicle Safety Standards by the National Highway Traffic Safety Administration). Be sure that your work is performed in accordance with such standards and that you do not disable any motor vehicle safety feature.

# INSTALL/REMOVAL INSTRUCTIONS: EVAP PRESSURE SENSOR REPAIR KIT

**ATTENTION:** Refer to the appropriate shop manual for your vehicle to obtain specific service procedures for this part. If you do not have a service manual or lack the skill to install this part, it is recommended that you seek the services of a qualified technician. Pay special attention to all cautions and warnings included in the shop manual. Read and follow all instructions carefully.

**STEP 4a:** For lengths shorter than the hose supplied, you will remove the line at the next barb. This is done by making a lengthwise slice over the barb with a box knife or other sharp bladed hand tool. Care must be taken to ensure the barb is not cut through. Once a lengthwise slice is in the line, apply downward pressure to the line, and it will split at the barb and come off.



**STEP 4b:** For lengths longer than the hose supplied to the next connector or barb, cut the nylon line at a length between 3" and full hose length supplied in the kit from the sensor down the nylon line. The nylon line can be sliced around the outside. Take care to make as even of a cut as possible, and find a straight part of the nylon line in order to install the compression fitting with no curve to interfere with the insert. **NOTE:** The old sensor and its attached nylon lines are now free from the vehicle, and this assembly can be saved for comparison for finished repair and then discarded.



**Disclaimer:**

Even though every attempt is made to ensure this information is complete and accurate, it is impossible to account for all possible circumstances or situations. Please consult with a qualified auto technician before attempting to perform any work you are not qualified to do. Automobiles can be hazardous to work on; be sure to take all necessary safety precautions. Failure to do so may result in property damage or personal injury. Certain motor vehicle standards and performance requirements may apply to your motor vehicle (such as Federal Motor Vehicle Safety Standards by the National Highway Traffic Safety Administration). Be sure that your work is performed in accordance with such standards and that you do not disable any motor vehicle safety feature.

©2018 Dorman Products, Inc.

No reproductions in whole or in part without prior written approval.

# INSTALL/REMOVAL INSTRUCTIONS: EVAP PRESSURE SENSOR REPAIR KIT

**ATTENTION:** Refer to the appropriate shop manual for your vehicle to obtain specific service procedures for this part. If you do not have a service manual or lack the skill to install this part, it is recommended that you seek the services of a qualified technician. Pay special attention to all cautions and warnings included in the shop manual. Read and follow all instructions carefully.

**STEP 5:** Cut the new hoses to length, if required, using the measurements from Step 3 or using the removed sensor and the attached lines for comparison.

## Installation Instructions

**STEP 1:** Push the new kit hoses on the new sensor barbs, ensuring the correct length hoses are on the correct side, and the sensor connector is facing the correct way.

**STEP 2:** If the compression fitting is NOT being used, **skip to Step 6.**

**STEP 3:** If the compression fitting IS being used, push the kit's nylon barbed compression fitting (3) into the correct hose side. Reference your discarded sensor and nylon line to ensure correct side and length.

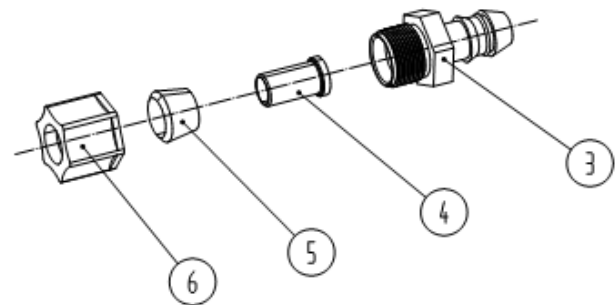

**Disclaimer:**

Even though every attempt is made to ensure this information is complete and accurate, it is impossible to account for all possible circumstances or situations. Please consult with a qualified auto technician before attempting to perform any work you are not qualified to do. Automobiles can be hazardous to work on; be sure to take all necessary safety precautions. Failure to do so may result in property damage or personal injury. Certain motor vehicle standards and performance requirements may apply to your motor vehicle (such as Federal Motor Vehicle Safety Standards by the National Highway Traffic Safety Administration). Be sure that your work is performed in accordance with such standards and that you do not disable any motor vehicle safety feature.

©2018 Dorman Products, Inc.

No reproductions in whole or in part without prior written approval.

# INSTALL/REMOVAL INSTRUCTIONS: EVAP PRESSURE SENSOR REPAIR KIT

**ATTENTION:** Refer to the appropriate shop manual for your vehicle to obtain specific service procedures for this part. If you do not have a service manual or lack the skill to install this part, it is recommended that you seek the services of a qualified technician. Pay special attention to all cautions and warnings included in the shop manual. Read and follow all instructions carefully.

**STEP 4:** Install the compression nut (6) to the nylon line with threads facing outwards, towards the cut end. Install the compression ferrule (5) over the nylon line next. Then place the insert (4), flange face out, inside the nylon line.

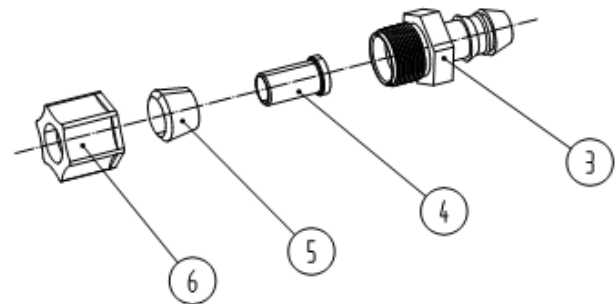

**STEP 5:** Draw the threaded nut over the ferrule and tighten the nut over the threads of the compression fitting. **DO NOT OVERTIGHTEN.** Tighten until it seats well and cannot turn by hand, then add a  $\frac{1}{4}$  turn by wrench to ensure seating. **TAKE CARE NOT TO STRIP THE THREADS.**



**Disclaimer:**

Even though every attempt is made to ensure this information is complete and accurate, it is impossible to account for all possible circumstances or situations. Please consult with a qualified auto technician before attempting to perform any work you are not qualified to do. Automobiles can be hazardous to work on; be sure to take all necessary safety precautions. Failure to do so may result in property damage or personal injury. Certain motor vehicle standards and performance requirements may apply to your motor vehicle (such as Federal Motor Vehicle Safety Standards by the National Highway Traffic Safety Administration). Be sure that your work is performed in accordance with such standards and that you do not disable any motor vehicle safety feature.

©2018 Dorman Products, Inc.

No reproductions in whole or in part without prior written approval.

# INSTALL/REMOVAL INSTRUCTIONS: EVAP PRESSURE SENSOR REPAIR KIT

**ATTENTION:** Refer to the appropriate shop manual for your vehicle to obtain specific service procedures for this part. If you do not have a service manual or lack the skill to install this part, it is recommended that you seek the services of a qualified technician. Pay special attention to all cautions and warnings included in the shop manual. Read and follow all instructions carefully.

**STEP 6:** Press the free end of hose over the sensor barb. If no compression fitting was used, this would be for both sides of the new sensor and hoses.



**STEP 7:** Verify the lengths again from the cut off original malfunctioning sensor and lines. Ensure the hoses were cut to proper length and the hoses can lay in position.

**STEP 8:** Reconnect the electrical connector to the sensor. On some models, the connector will need replacement. If the connector does not match, reference your service manual or check the pin outs of the connector coming from the main harness and follow Steps a-g to install the new pigtail:

- a. The pigtail has the following pin outs:
  - i. Purple wire: VREF (5 volt reference power)
  - ii. Black Wire: SIGNAL RETURN (GND)
  - iii. Gray wire: Signal Wire (VOUT)
- b. Cut off the original connector, and strip the wires on the main harness
- c. Using the kit butt splice, connect VREF (purple) of the pigtail to VREF (REFERENCE VOLTAGE) of the vehicle
- d. Using the kit butt splice, connect GND (black) of the pigtail to GND (GROUND) of the vehicle.
- e. Using the kit butt splice, connect VOUT (gray) of the pigtail to VOUT (SIGNAL) of the vehicle.
- f. Crimp and shrink or tape the butt splice connections.
- g. Plug the new connector to the sensor.

**STEP 9:** Reinstall the tank and/or the vapor lines.

Disclaimer:

Even though every attempt is made to ensure this information is complete and accurate, it is impossible to account for all possible circumstances or situations. Please consult with a qualified auto technician before attempting to perform any work you are not qualified to do. Automobiles can be hazardous to work on; be sure to take all necessary safety precautions. Failure to do so may result in property damage or personal injury. Certain motor vehicle standards and performance requirements may apply to your motor vehicle (such as Federal Motor Vehicle Safety Standards by the National Highway Traffic Safety Administration). Be sure that your work is performed in accordance with such standards and that you do not disable any motor vehicle safety feature.

©2018 Dorman Products, Inc.

No reproductions in whole or in part without prior written approval.

# INSTALL/REMOVAL INSTRUCTIONS: EVAP PRESSURE SENSOR REPAIR KIT

**ATTENTION:** Refer to the appropriate shop manual for your vehicle to obtain specific service procedures for this part. If you do not have a service manual or lack the skill to install this part, it is recommended that you seek the services of a qualified technician. Pay special attention to all cautions and warnings included in the shop manual. Read and follow all instructions carefully.

**STEP 10:** Once the repair is completed, ensure no hoses are pinched.

**STEP 11:** Reconnect battery and test drive.



Completed repair example

**We appreciate your opinions regarding this product!  
Please call our Technical Assistant with any challenges or suggestions  
regarding the installation or operation of this product.**

**1-800-523-2492**

Disclaimer:

Even though every attempt is made to ensure this information is complete and accurate, it is impossible to account for all possible circumstances or situations. Please consult with a qualified auto technician before attempting to perform any work you are not qualified to do. Automobiles can be hazardous to work on; be sure to take all necessary safety precautions. Failure to do so may result in property damage or personal injury. Certain motor vehicle standards and performance requirements may apply to your motor vehicle (such as Federal Motor Vehicle Safety Standards by the National Highway Traffic Safety Administration). Be sure that your work is performed in accordance with such standards and that you do not disable any motor vehicle safety feature.

©2018 Dorman Products, Inc.

No reproductions in whole or in part without prior written approval.